

Top View

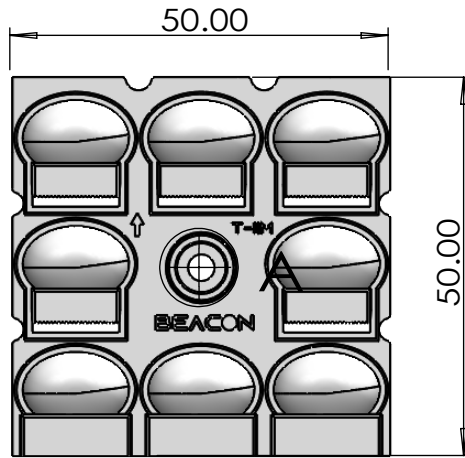

Bottom View

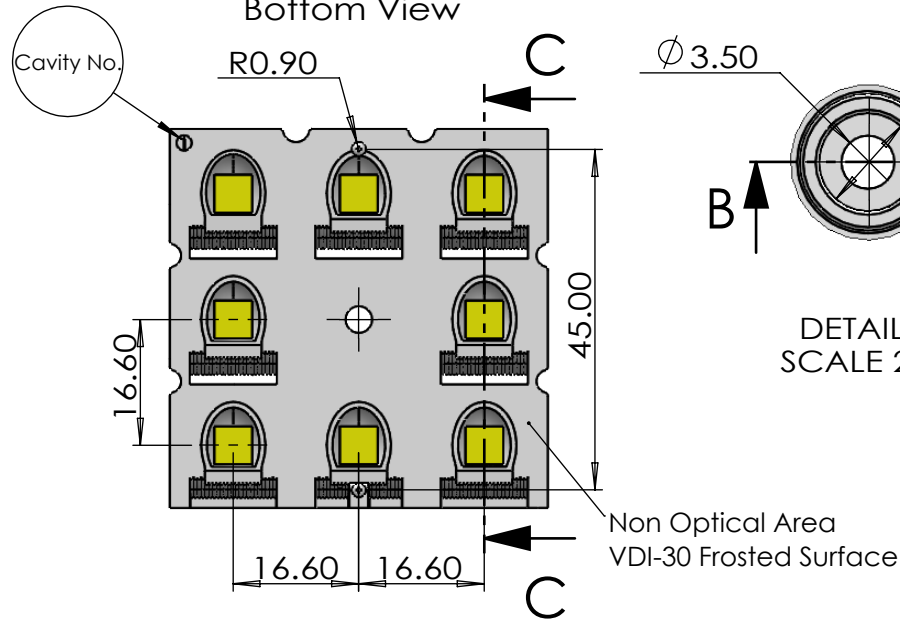

Front View

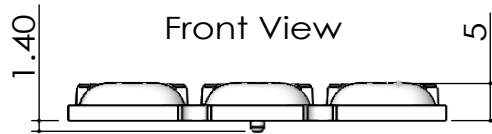

SECTION C-C

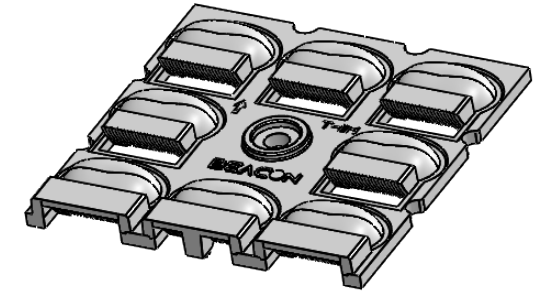
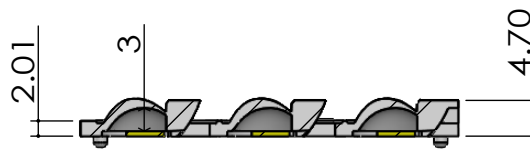

Isometric View

- Lens Material : Polycarbonate(Makrolon 2407&2647/Teijin 1225Z)
- Operating Temperature : PC: -40°C~+110°C(Upper Limit +120°C)
- UL Flammability : PC 2407/1225Z: V-2 @0.75mm & HB @2.7mm
- UL RTI Elec : PC 2407/1225Z: 125°C @1.5mm
- Light Transmission Rate 400nm~900nm > 90%



BEACON OPTRONICS
The Shape of Light

Plastic Moulding General Tolerances if not otherwise shown According to DIN ISO 2768-1 Linear measures: up to 30mm class M, otherwise class C According to DIN ISO 2768-2 Form and position: class L

DO NOT SCALE DRAWING

FIRST ANGLE PROJECTION

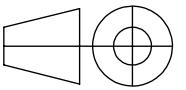
**BEACON OPTRONICS**

	NAME	SIGNATURE	DATE	Family	
DRAWN	Ankur Sharma	Ankur Sharma	11.09.2024	Jupiter Series	
CHK'D	Anuj Sharma	Anuj Sharma	11.09.2024		
APPV'D	Pradyumna Shandilya	Pradyumna	11.09.2024		
MATERIAL:	Polycarbonate(Makrolon 2407,Teijin 1225Z)			PRT NO.	BO118-Jupiter-8x1-5050-Type-IIM(155x70°)
1:-All Dimensions are in mm 2:-Open Tolerance is +/- 0.2	This drawing is the property of Beacon Optronics. It may not be reproduced, copied or communicated without a written agreement with Beacon Optronics.			DWG NO.	BO118
				A4	
				REVISION-00	
WEIGHT: 7.5Gm				SCALE:1:1	SHEET 1 OF 1